





THIS DRAWING IS A PART OF A SET OF DRAWINGS AND SHOULD BE REFERRED TO IN CONJUNCTION WITH THE OTHER DRAWINGS IN THE SET.

ALL DIMENSIONS ARE IN ACCORDANCE WITH THE SAAS RULES UNLESS OTHERWISE SPECIFIED.

ALL FINISHES TO BE IN ACCORDANCE WITH THE SAAS RULES UNLESS OTHERWISE SPECIFIED.

ALL FINISHES TO BE IN ACCORDANCE WITH THE SAAS RULES UNLESS OTHERWISE SPECIFIED.

ALL FINISHES TO BE IN ACCORDANCE WITH THE SAAS RULES UNLESS OTHERWISE SPECIFIED.

SPECIFICATIONS	
EXTERNAL WALL	0.25 W/m <sup>2</sup> K
FLOOR	0.18 W/m <sup>2</sup> K
ROOF	0.18 W/m <sup>2</sup> K
WINDOWS	1.8 W/m <sup>2</sup> K
DOORWAYS	1.8 W/m <sup>2</sup> K
GLASS	1.8 W/m <sup>2</sup> K
PERSONNEL DOORS	1.8 W/m <sup>2</sup> K
LOADING DOORS	1.3 W/m <sup>2</sup> K

**CILING FINISHES**

OFFICE AND STAIRCASE AREAS SHALL BE FITTED WITH HEAVYDUTY ACRYLIC COMBIBOND CARPET TILES. EXAMPLE SPECIFICATION: BUNCE PARAGON 6700. REFERENCE: MCBURY, 877618.

CHANGE AREA & VITICHETTE SHALL BE PROVIDED WITH WOOD BEET FLOOR FINISH. COLOR: Forest Grey AND THE FLOOR.

**NOTING NOTES:**  
OFFICE AREA TO HAVE TIMBER SURFACES THROUGHOUT IN 25 x 100mm AMERICAN LUMBER OAK.

01 SPECIFICATIONS

hatch architects

McLAREN GARBE  
Industrial Real Estate

Project: Sheequeh Common, Workshop

Drawing No: GATEHOUSE FLOOR FINISHES PLAN

Scale: 1:50

Construction Issue: 5/21/2024

1.05 SCA 02 03 04 05 06 07 08 09 10 11 12 13 14 15 16 17 18 19 20 21 22 23 24 25 26 27 28 29 30 31 32 33 34 35 36 37 38 39 40 41 42 43 44 45 46 47 48 49 50 51 52 53 54 55 56 57 58 59 60 61 62 63 64 65 66 67 68 69 70 71 72 73 74 75 76 77 78 79 80 81 82 83 84 85 86 87 88 89 90 91 92 93 94 95 96 97 98 99 100

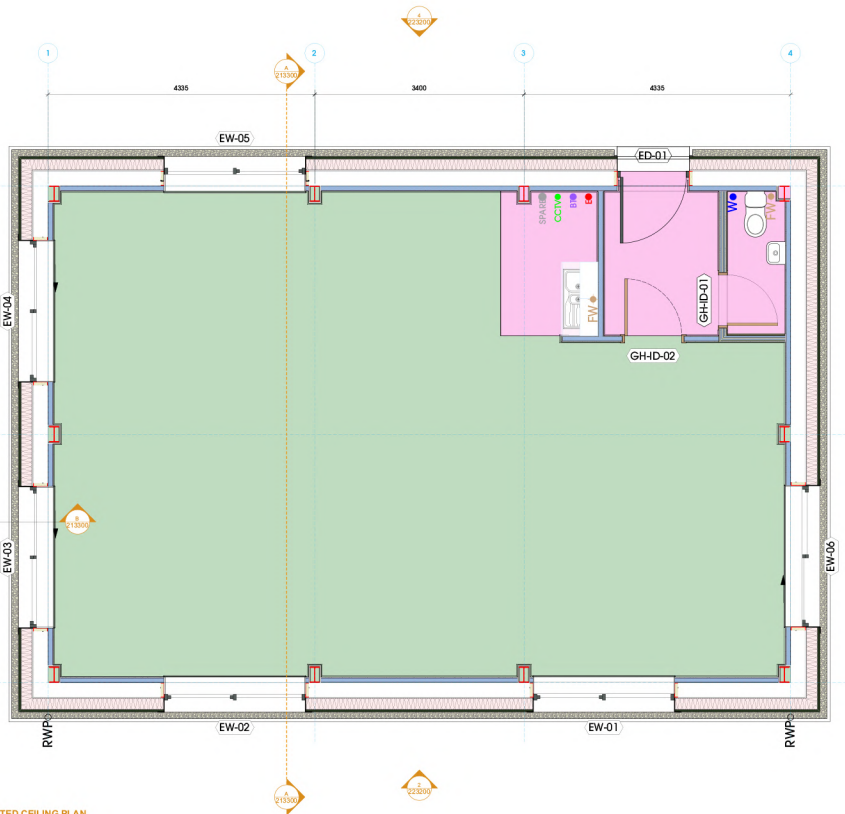

2 GATEHOUSE REFLECTED CEILING PLAN  
SCALE: 1:25







